

SPECIFICATIONS

DIMENSIONS

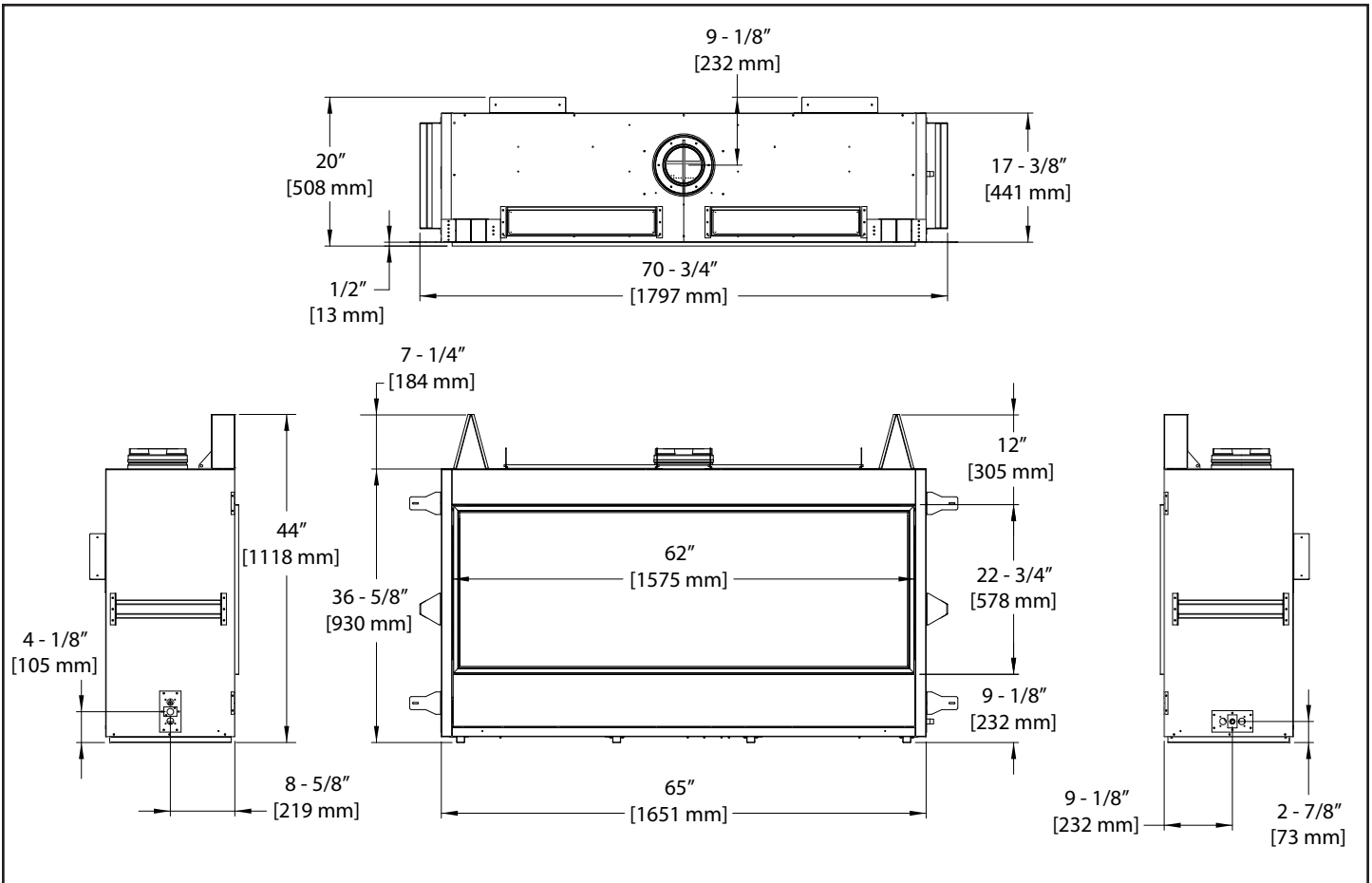

Figure 1: Unit Dimensions

RATING LABEL & LIGHTING INSTRUCTIONS LOCATION

Remove the screen to access the rating label and lighting instructions. The plates are attached to a length of chain and are never to be tampered with or removed. All important information for your fireplace is on this label as well of the model specific serial number which you will need for warranty information. The plates are located inside the cabinet on the left side near the front.